

- 1. INFINIRAIL
- 2. DIAMOND FASTENER (APPROX. EVERY 16" ON INFINIRAIL)
- 3. SPLICE PLATE (5" WIDTH)
- 4. 6100 SERIES MESH
- 5. AMICLAMP

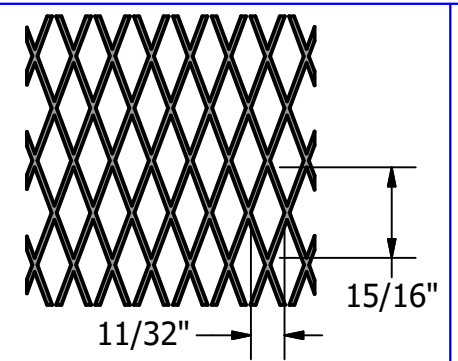

6100 SERIES MESH

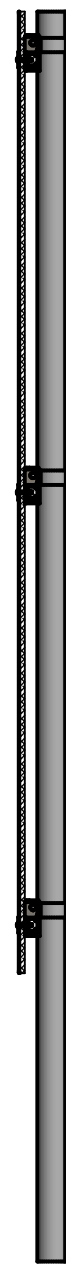
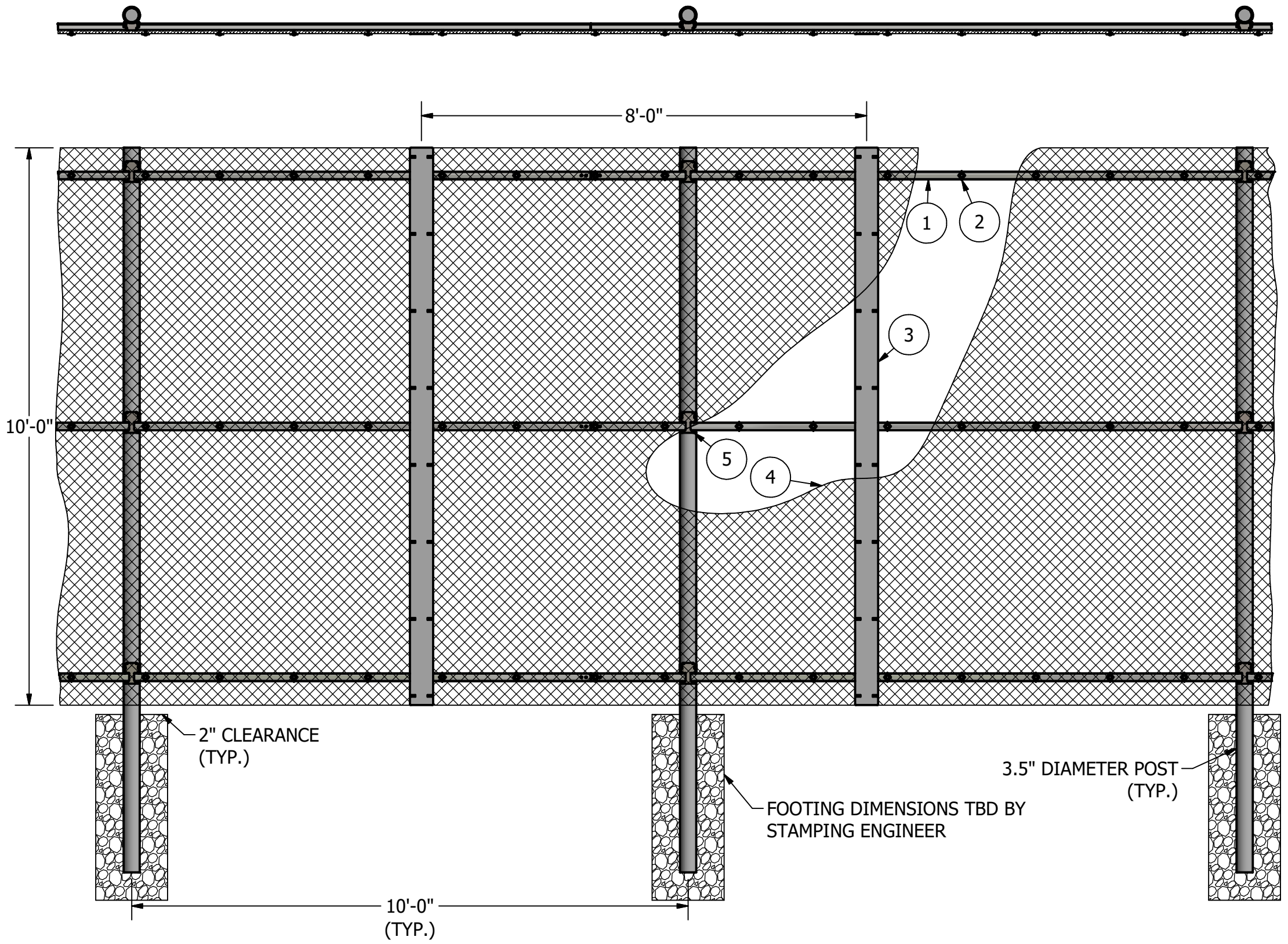

REV	DATE	DESCRIPTION	C/C	BY
0	5/14/2019	FOR APPROVAL		

CHAMELEON 6100 10FT TALL 3 RAIL 10FT OC ELEVATION		MATERIAL SPECIFICATIONS	
PROJECT	FINISH	DRAFTER	REVIEWER
CUSTOMER		C. COUVILLON	
SO#			
QUOTE#			
DATE			
5/14/2019			

A36 STEEL: ALL PLATE ANGLE & CHANNEL
A500 GRADE B: ALL TUBE STEEL
COMMERCIAL GALV: ALL GA WIRE

SHEET NO.
A3

THIS DRAWING IS THE PROPERTY OF AMICO, INC., AND IS CONFIDENTIAL AND MUST NOT BE MADE PUBLIC OR COPIED, AND IS SUBJECT TO RETURN ON DEMAND. ALL RIGHTS OF INVENTION OR DESIGN ARE RESERVED.

NOTE: POST SIZE BASED ON 105 MPH WIND LOAD.